

**HYCO**  
Manufacturing Ltd

# Handyflow Undersink Vented Water Heater

Model HF05VC  
Instruction Manual

Version 3.0 June 2010

### 3. PLUMBING CONNECTIONS

The hot and cold fittings are at the top of the unit. These connections are colour coded (blue = cold, red = hot). They are **NOT** interchangeable.

All fittings are provided so connection can be made via 15mm compression fittings.

Please follow manufacturers instructions provided with the vented tap.

The diagrams below show typical installation with the Hyco Vented mixer tap HFTAPQ

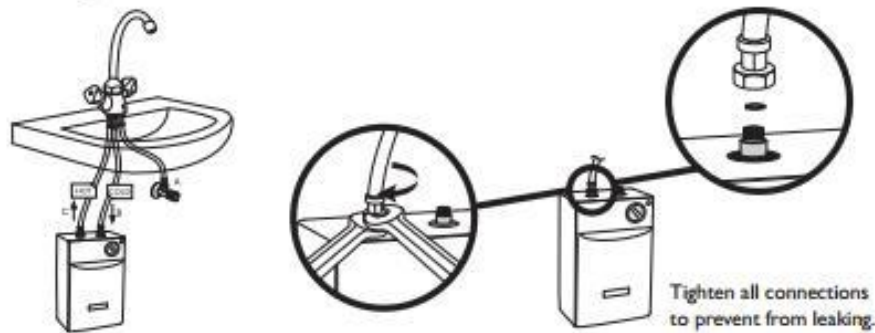

### 4. ELECTRICAL INSTALLATION

The Electrical Installation must be carried out by a qualified electrician in accordance with the current edition of the I.E.E. Wiring Regulations.

Only connect the heater to a single phase supply with a mains voltage as specified on the rating plate.

Electrical connection must be made to the fixed wiring of the property by means of a 13A fused spur. The installation must be fitted with an isolating switch, with a break contact distance of at least 3mm.

This appliance must be earthed.

The unit is supplied pre-wired. If the cable needs replacing, it must be replaced with a correctly rated cable and any work should be carried out by a competent person.



IN ORDER TO AVOID A HAZARD DUE TO INADVERTENT RESETTING OF THE THERMAL CUT-OUT, THIS APPLIANCE MUST NOT BE SUPPLIED THROUGH AN EXTERNAL SWITCHING DEVICE, SUCH AS A TIMER, OR CONNECTED TO A CIRCUIT THAT IS REGULARLY SWITCHED ON AND OFF BY THE UTILITY.



The unit is fitted with an auto-reset thermal cut-out which will operate for safety reasons in the event of the unit over heating. To reset the thermal cut-out switch off the power to the unit and allow it to cool down. Ensure the unit is full, and then switch the unit back on. The thermal cut-out should reset itself.

## 5. OPERATION

Switch on power to the unit and select the desired temperature setting<sup>1</sup>. The indicator is lit when the element is on.

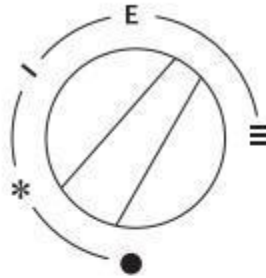

●	OFF
*	Frost protection. Element will switch on when water temperature falls below 7°C
I	Heats water to approx 25°C
E	Economy position. Heats water to approx 55°C
≡	Max temperature approx 80°C

<sup>1</sup> Operating the unit at a lower temperature can reduce scaling, save energy and reduce the risk of scalding

## 6. TECHNICAL SPECIFICATIONS

<b>MODEL</b>	<b>HF05VC</b>
<b>SUPPLY</b>	230V ~ 50Hz
<b>POWER</b>	2kW
<b>CAPACITY</b>	5L
<b>IP RATING</b>	IP24
<b>OVER-TEMPERATURE DEVICE</b>	Auto reset

## 7. GUARANTEE AND SERVICE POLICY







This product is guaranteed against faulty materials and manufacture for a period of one year from the date of purchase. Hycow will in its sole discretion replace, repair or refund any faulty unit. Incorrect installation and consequences of limescale deposits are excluded. Consequential costs such as labour charges or damage to surroundings are expressly excluded.

## HYCO HANDYFLOW VENTED WATER HEATER MODEL HF05VC

### 1. INTRODUCTION

Thank you for purchasing the Hyco Handyflow undersink vented water heater. The unit comes pre-wired and complete with vented mixer tap and flexible hoses. The unit also features an auto-reset thermal cut-out eliminating the need to change thermal fuses, making it particularly useful if the unit is likely to be drained frequently. Please read and understand these instructions before commencing installation, and leave them with the user when installation is complete.

### CAUTION

-  THE HANDYFLOW MUST BE INSTALLED AND MAINTAINED BY A COMPETENT PERSON IN ACCORDANCE WITH CURRENT ELECTRICAL AND PLUMBING REGULATIONS.
-  IT IS ESSENTIAL THAT ONLY OPEN OUTLET FITTINGS ARE USED WITH THE HANDYFLOW SO THE UNIT IS NOT PRESSURISED (VENTED MIXER TAP AND HOSES SUPPLIED).
-  ALWAYS FIT THE HEATER THE CORRECT WAY UP. (PIPES SHOULD BE AT THE TOP)
-  USE LOWEST ACCEPTABLE TEMPERATURE SETTING TO SAVE ENERGY AND REDUCE LIMESCALE
-  DO NOT CONNECT TO POWER UNLESS UNIT IS FULL OF WATER – OPEN HOT OUTLET AND ALLOW WATER TO FLOW FREELY TO CLEAR AIRLOCKS
-  DO NOT SWITCH POWER ON IF WATER OR PIPES COULD BE FROZEN

### 2. INSTALLATION (WALL MOUNTING)

The Handyflow is normally fitted immediately below the outlet to be supplied, but it can be mounted above or to the side of the outlet provided it is vertical with the pipe outlets at the top. The unit can either be placed directly on the floor or fixed to a wall using the fixings provided.

-  ENSURE THE MOUNTING SURFACE IS STRONG ENOUGH TO SUPPORT THE HANDYFLOW INCLUDING THE WEIGHT OF THE WATER.

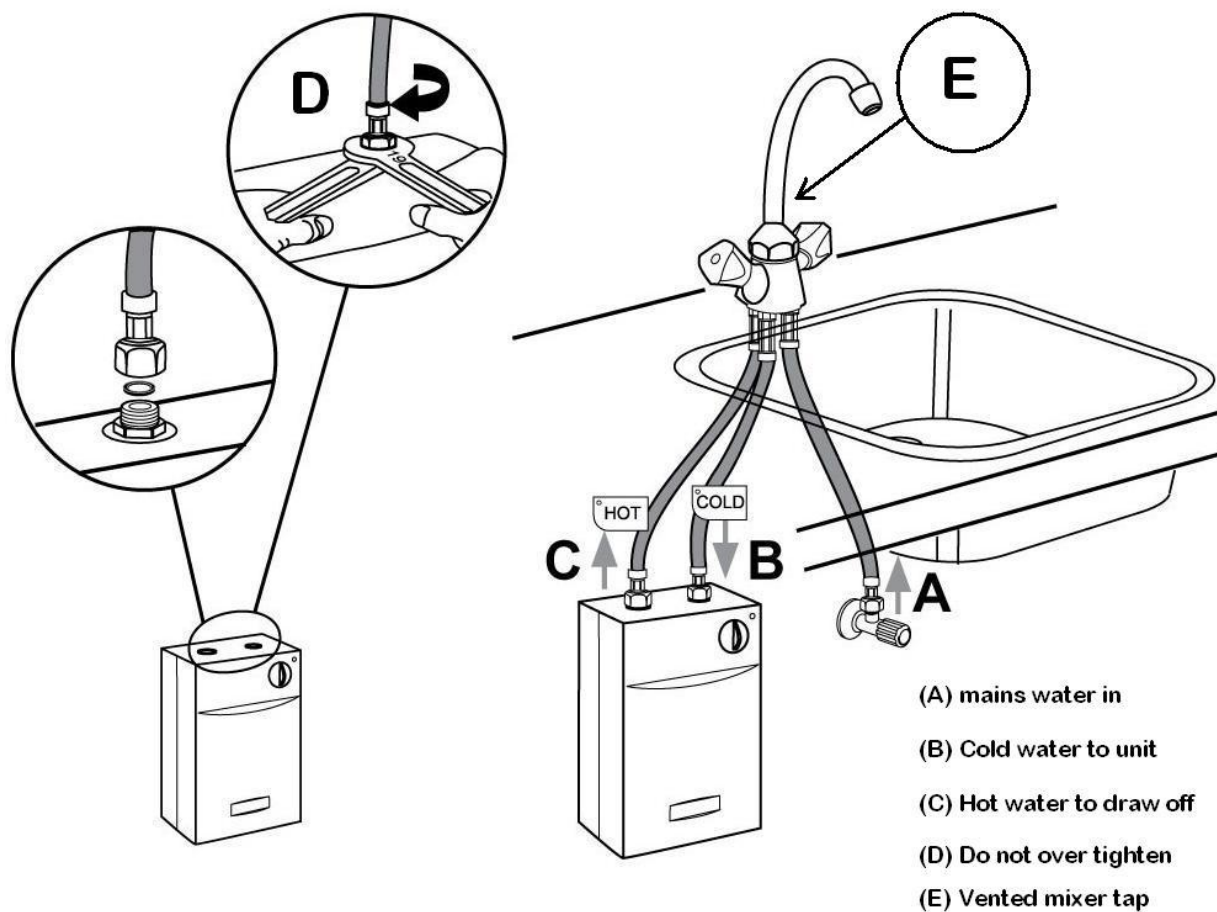



[www.hycowaterheaters.co.uk](http://www.hycowaterheaters.co.uk)